

© heli sitterdorf • standard circuit • version 6.0 / 09.03.04 / cm

DEP Briefing

- Departure procedure / sector
- HIGE / HOGE
- Limitations (LMP / MCP / V_{NE})
- Emergency

R44 Raven

BRIEFINGS & CHECKS

APP Briefing

- REKO (W A HI BEL U)
- HIGE / HOGE
- Limitations (LMP / MCP / V_{NE})
- Emergency / Escape

Check bef. DEP

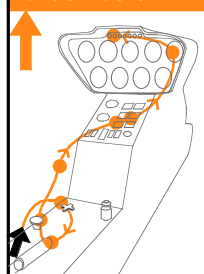

- Friction's: OFF
- Governor: ON
- Carb Heat: as required
- Ldg. light: as required
- Fuel: ... ENDURANCE
- T's & P's: GREEN
- RPM: 102%
- NO warnings/cautions

Climb check

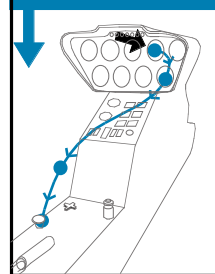

- Climb speed: 60 KIAS
- Power: 22 inch MCP
- Ldg. light: as required
- Carb heat: as required

Check for APP

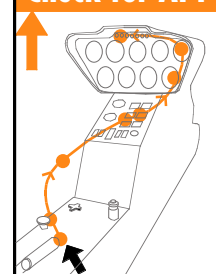

- Governor: ON
- Carb Heat: ON
- Ldg. light: as required
- Fuel: ... ENDURANCE
- T's & P's: GREEN
- Power: 18 inch MP
- RPM: 102%
- NO warnings/cautions

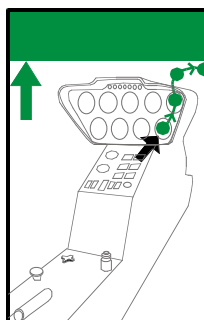

- Power: ... inch MP
- RPM: 102%
- Wind: ...
- DEP Sector: CLEAR

Cruise check

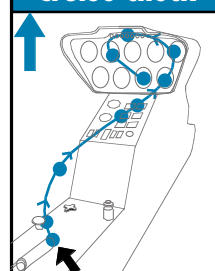

- Governor: On
- Carb heat: as required
- Ldg. light: as required
- Fuel: ... ENDURANCE
- T's & P's: GREEN
- Power: 20 inch MP
- RPM: 102%
- NO warnings/cautions
- Altimeter: as required
- Gyro: adjust

Final check

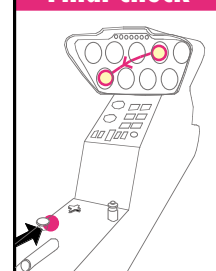

- @ 40 KIAS:
- Carb heat: as required

Safety window: 

- 30 KIAS / 300 ft ROD
- Decision: -> Land / Go around